

DATA SHEET – DS07
JOISTED FLOORS
XPS INSULATION SYSTEM

PRODUCT INFORMATION

Typical UFH kit items:

- UFH 16mm Pipe
- Grooved Universal XPS Insulation
- 16mm Pipe Bend Supports
- Manifold Arms
- Manifold Pump / Mixer
- 1" Isolation Valves
- 16mm Manifold Pipe Connections
- Thermostat/s
- Wiring Centre
- Actuators (if more than one thermostat supplied)

XPS INSULATION SYSTEM DATA

- The UFH pipe is:
 - o 16x2mm 5-Layer PERT
- The pipe can be installed in:
 - o A serpentine 'up-and-down' pattern
- The pipe centres can be:
 - o 150mm
 - o 200mm
- XPS Insulation Sheet Sizes:
 - o 1,200mm x 345mm x 50mm
 - o 1,200mm x 545mm x 50mm

TYPICAL XPS INSULATION SYSTEM SECTION:

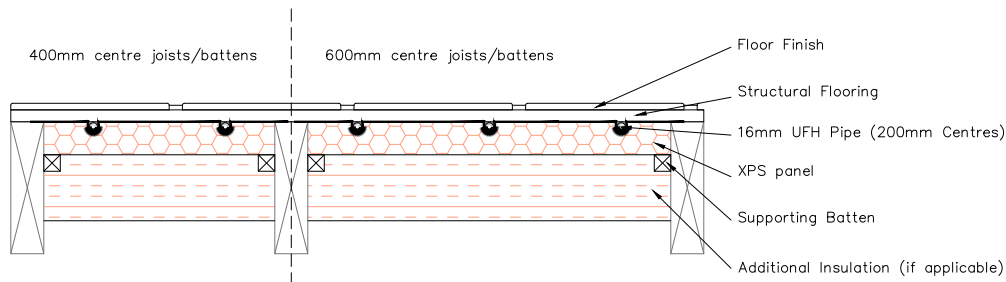

TYPICAL XPS INSULATION SYSTEM HEAT OUTPUTS:

FLOOR FINISH	TOG RATING	WATER FLOW TEMP	
		55 @ 200cc	45 @ 200cc
TILES	0.1 TOG	78W/m ²	53W/m ²
15mm ENGINEERED WOOD	1.0 TOG	61W/m ²	40W/m ²
CARPET	1.5 TOG	49W/m ²	33W/m ²