

DATA SHEET – DS04
FLOATING FLOORS
INSULATION SYSTEM

PRODUCT INFORMATION

Typical UFH kit items:

- UFH 16mm Pipe
- XPS Insulation Panels
- 16mm Pipe Bend Supports
- Manifold Arms
- Manifold Pump / Mixer
- 1" Isolation Valves
- 16mm Manifold Pipe Connections
- Thermostat/s
- Wiring Centre
- Actuators (if more than one thermostat supplied)

FLOATING FLOOR SYSTEM DATA

- The UFH pipe is:
 - o 16x2mm 5-Layer PERT
- The pipe can be installed in:
 - o A serpentine 'up-and-down' pattern
- The pipe centres can be:
 - o 150mm
 - o 200mm
- Insulation thicknesses:
 - o 25mm/35mm/50mm
- Insulation Panel Size:
 - o 1,200mm x 600mm x 25/35/50mm

TYPICAL FLOATING FLOOR SYSTEM SECTION:

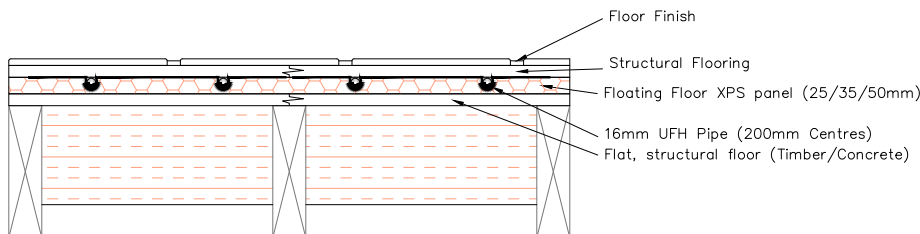

TYPICAL FLOATING FLOOR HEAT OUTPUTS:

FLOOR FINISH	TOG RATING	WATER FLOW TEMPERATURE			
		55 @ 150cc	45 @ 150cc	55 @ 200cc	45 @ 200cc
TILES	0.1 TOG	91W/m ²	61W/m ²	78W/m ²	53W/m ²
15mm ENGINEERED WOOD	1.0 TOG	70W/m ²	47W/m ²	61W/m ²	40W/m ²
CARPET	1.5 TOG	57W/m ²	38W/m ²	49W/m ²	33W/m ²