

DATA SHEET – DS08
JOISTED FLOORS
CHIPBOARD SYSTEM

PRODUCT INFORMATION

Typical UFH kit items:

- UFH 12mm Pipe
- Grooved Universal Chipboard
- OPTIONAL 9mm TnG MDF Overlay
- 12mm Pipe Bend Supports
- Manifold Arms
- Manifold Pump / Mixer
- 1" Isolation Valves
- 12mm Manifold Pipe Connections
- Thermostat/s
- Wiring Centre
- Actuators (if more than one thermostat supplied)

CHIPBOARD SYSTEM DATA

- The UFH pipe is:
 - o 12x2mm 5-Layer PERT
- The pipe can be installed in:
 - o A serpentine 'up-and-down' pattern
- The pipe centres can be:
 - o 150mm
- Chipboard Sheet Sizes:
 - o 2,400mm x 600mm x 22mm
- Optional MDF Overlay Sheet Sizes:
 - o 1,200mm x 600mm x 9mm

TYPICAL CHIPBOARD SYSTEM SECTION:

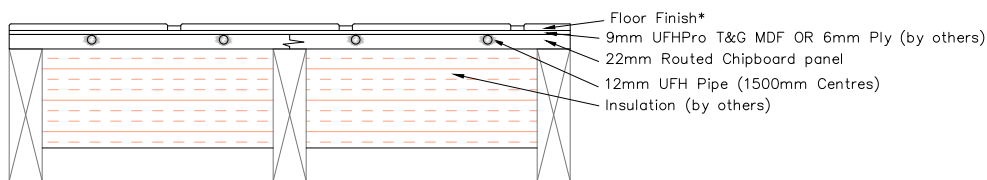

*Minimum 8mm timber can be laid directly on top. Any other floor covering will require minimum 6mm ply.

TYPICAL CHIPBOARD SYSTEM HEAT OUTPUTS:

FLOOR FINISH	TOG RATING	WATER FLOW TEMP	
		55 @ 150cc	45 @ 150cc
TILES	0.1 TOG	92W/m ²	62W/m ²
15mm ENGINEERED WOOD	1.0 TOG	80W/m ²	54W/m ²
CARPET	1.5 TOG	71W/m ²	49W/m ²